

DIAPHRAGM SENSING PRESSURE SUSTAINING VALVE PS15SS DN 1/4" – 1/2"; DN15

DESCRIPTION

The ADCA PS15 series **direct acting, spring-loaded diaphragm sensing**, pressure sustaining valves, are designed for use on steam, compressed air and other gases compatible with the materials of the construction. They are suitable for pressure sustaining applications where low capacity is required.

In general this valve maintains the upstream pressure under control.

Connections are female screwed or flanged.

MAIN FEATURES

Compact design.

Machined from barstock materials.



OPTIONS:

Metal to metal or soft valve.
1/4" gauge connection on body.
Panel mounting nut and thread.
Straight or angle connections.

USE:

Compressed air other gases compatible with the construction.
Special version available for steam, on request.

AVAILABLE MODELS:

PS15SS – Stainless steel.

SIZES:

DN 1/4", 3/8" and 1/2".
DN 15

CONNECTIONS:

Female screwed ISO7/1Rp(BS 21) or NPT.
Flanged EN 1092-1 PN16/PN40
Special flanges upon request.

INSTALLATION:

Horizontal installation.
An "Y" strainer should be provided upstream the valve.
See IMI, installation and maintenance instructions

ORDER REQUIREMENTS:

Type of fluid
Maximum operating temperature
Required opening pressure
Capacity (maximum and minimum).

CAPACITIES

Valve Size	1/4"	3/8"	1/2"
KVs (m3/h)	1,15	1,15	1,35

LIMITING CONDITIONS

Valve model	PS15SS
Body design conditions	PN 63
Max.upstream pressure	15 bar
Min.upstream pressure	0,2 bar
Max.design temperature *	80 °C

*Other on request.

CE MARKING (PED - European Directive 97/23/EC)

PN 16-PN63	Category
DN 8 to 15	SEP - art. 3, paragraph3

DIMENSIONS (mm)-Screwed						EN 1092-1 Flanges		
SIZE DN	A	A1	B	C	WGT. Kgs	D*	E	WGT. Kgs
1/4"	80	60	20	200	2,4	-	-	-
3/8"	80	70	20	200	2,8	-	-	-
1/2"-15	80	-	20	200	3,3	150	47,5	4,7

* Different lenghts on request.

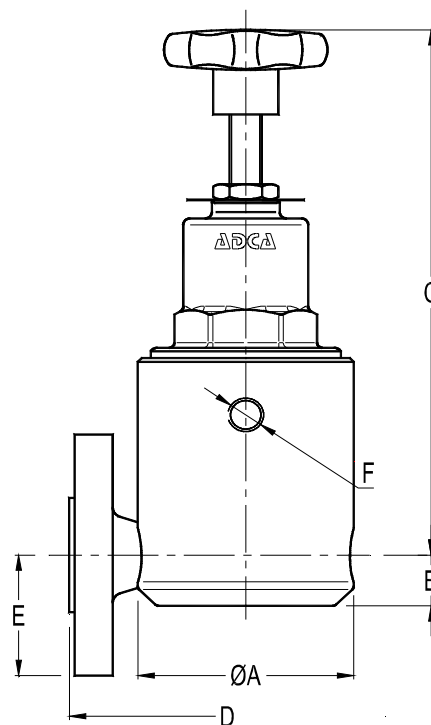
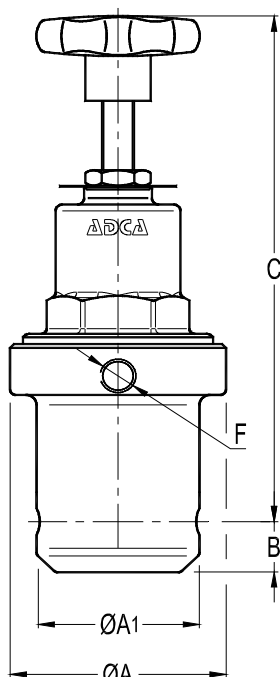

MATERIALS		
POS.	DESIGNATION	MATERIAL
1	VALVE BODY	AISI316 / 1.4401 ; CF8M / 1.4408
2	TOP COVER	AISI316 / 1.4401 ; CF8M / 1.4408
3	SEAT	AISI316 / 1.4401
4	PUSHROD	AISI316 / 1.4401
6	*VALVE SPRING	AISI302 / 1.4300
8	*VALVE HEAD	NBR-EPDM-PTFE,etc
10	* DIAPHRAGM	AISI301 / 1.4310
11	* GASKET	ST.STEEL GRAPHITE
12	* GASKET	ALUMINIUM
13	SPRING PLATE	BRASS
15	* ADJUSTMENT SPRING	SPRING STEEL
16	TOP SPRING PLATE	BRASS
17	ADJUSTMENT SCREW	AISI304 / 1.4301
18	LOCKNUT	ST.STEEL A2-70
19	HANDWHEEL	PLASTIC
20	SPRING IDENT. PLATE	ALUMINIUM

* Available spare parts.

Remarks: All valves has a serial number. In case of non-standard valves this number must be supplied if spare parts are ordered.

